

PEDAL SLIDER BASEPLATE

VERSION 1.1

LAST UPDATED: 17-02-2025

Before you start:

Firstly we would just like to say thank you for purchasing your new Vitus Components Product. Now its time to start the build! This instruction manual will help and guide you through the build process step-by-step. Below is some key information along with the tools required to complete assembly. The next page you will see the bill of materials, please ensure you have all the correct hardware and that everything has been delivered safely.

Compatibility:

The Universal Pedal Slider Baseplate is compatible with all profile aluminum profile rigs. There are multiple ways of mounting the baseplate. This can be done either with the (seat) slider or you can directly mount the baseplate to the profile on your pedal tray. There is detailed step-by-step instructions for both options. We have also listed what pedals are capable of mounting to this baseplate.

Inserting Slot-Nuts:

There is nothing worst than completing your build just finished putting the end caps on and then realizing you need to use more slot nuts! Don't worry we have got you! Please see the illustration showing a real simple and easy way to insert the slot-nuts into the profile from the side. Once in you can simply slide the slot nut up and down the profile to your desired location. Some times using your allen key to assist can make life easier.

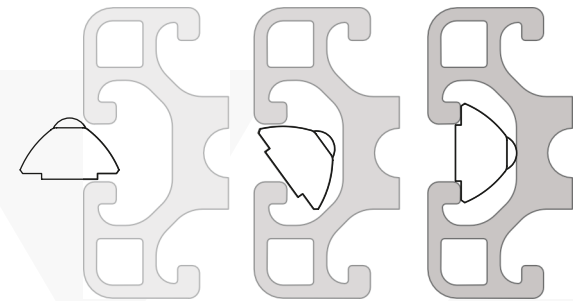

Tools required:

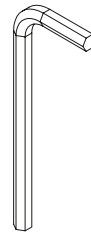

4/5/6MM

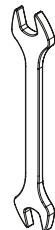

8/10/13MM

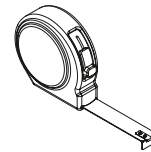

Hardware Checklist:

PEDAL BASEPLATE

#	Part	QTY	Note
A1	Pedal base plate	1	
A2	Bolt M8 X 16 DIN 912	4	
A3	Bolt M8 X 12 DIN 912	4	
A4	Bolt M6 X 20 DIN 912	12	
A5	Bolt M5 X 25 DIN 912	12	
A6	Bolt M8 X 20 DIN 7991	4	Countersunk
A7	Washer M8 DIN 125-A	8	
A8	Spacer male/female M8 X 15	4	
A9	Slot-Nut M8	6	
A10	Lock-Nut M8	10	
A11	Lock-Nut M6	12	
A12	Lock-Nut M5	12	

SEAT SLIDER (optional purchase)

#	Part	QTY	Note
B1	Seat slider LEFT	1	
B2	Seat slider RIGHT	1	
B3	Seat slider handle	1	

SEAT SLIDER (optional purchase)

C1	Heel rest	1	
C2	Bolt M6 X 45 DIN 7991	4	Countersunk
C3	Bolt M6 X 35 DIN 7991	4	Countersunk
C4	Plastic sleeve M8 X 20	4	
C5	Plastic sleeve M8 X 10	4	
C6	Slot-Nut M6	4	
C7	Lock-Nut M6	4	

Slot-Nut M8

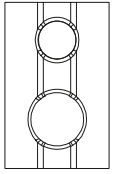

4X

Going to install the optional seat sliders? Please skip to page 5.

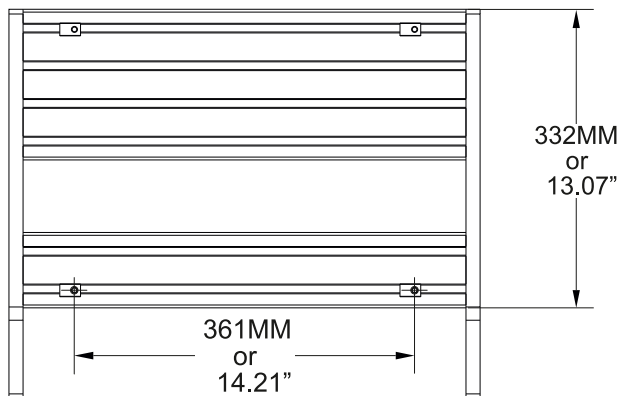
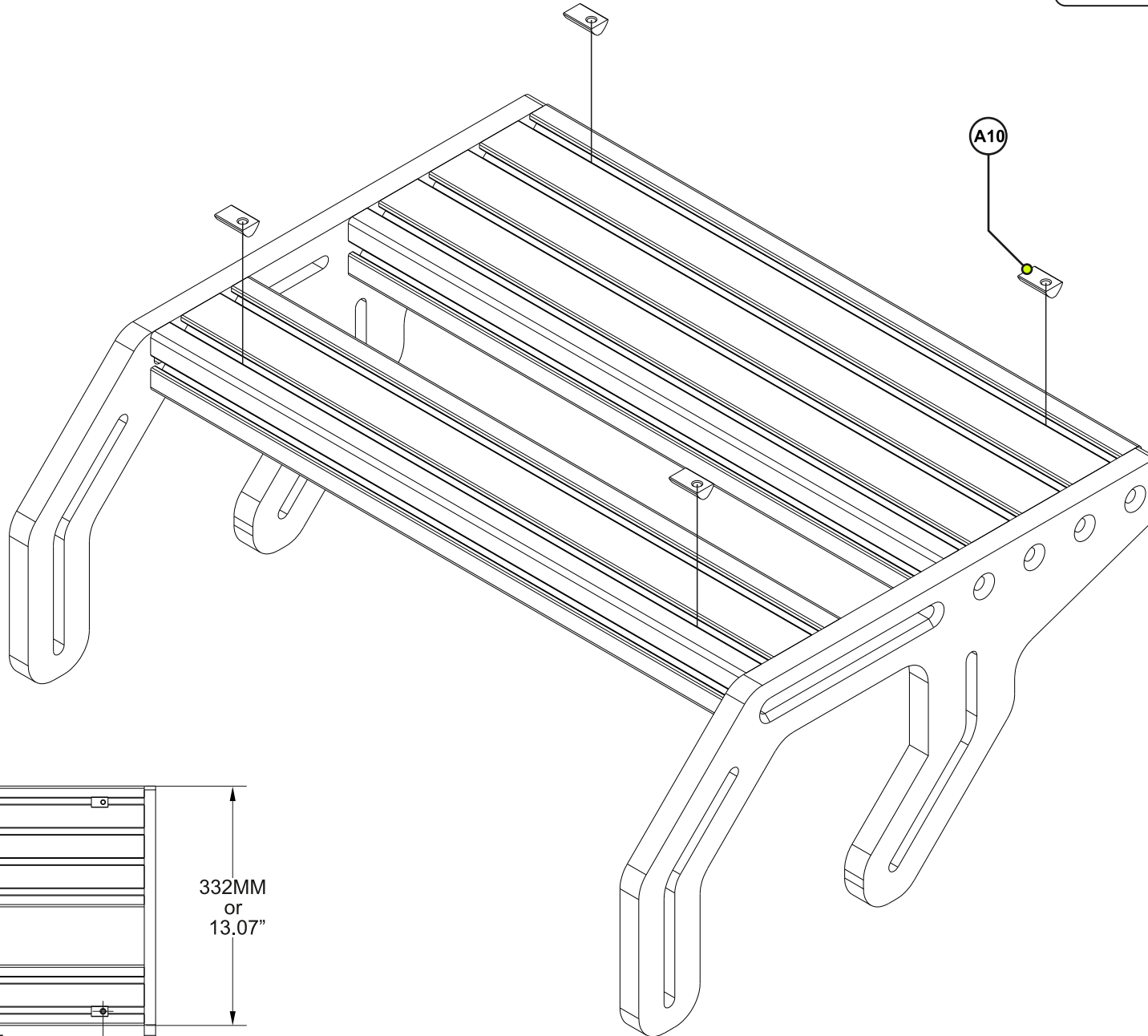

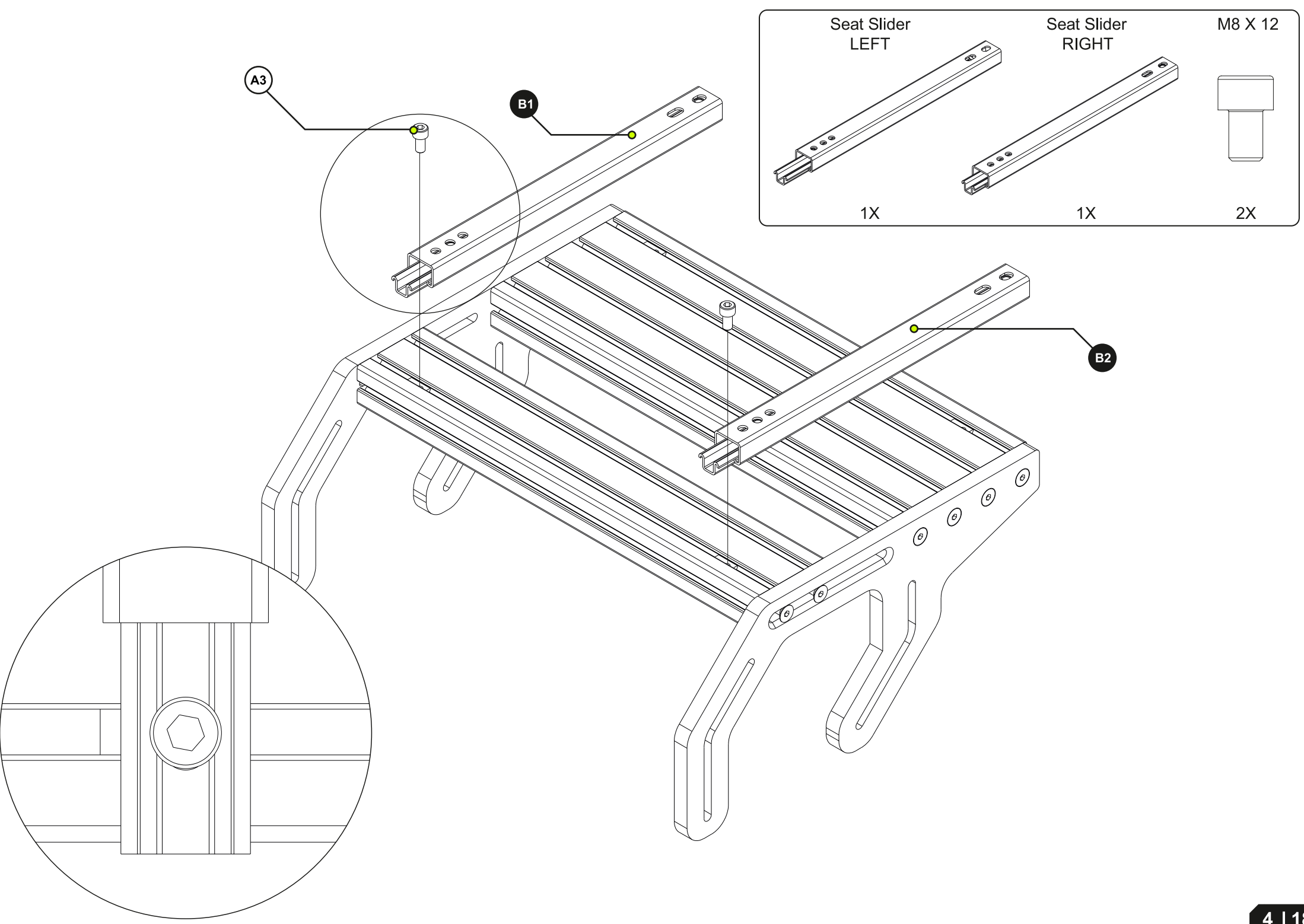

Slot-Nut M8

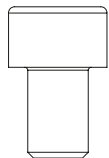

2X

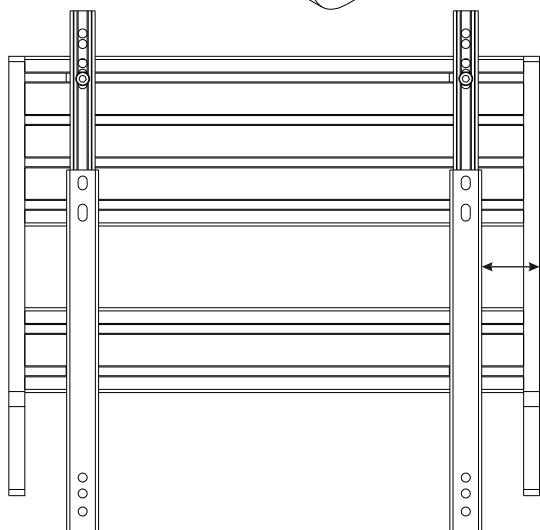
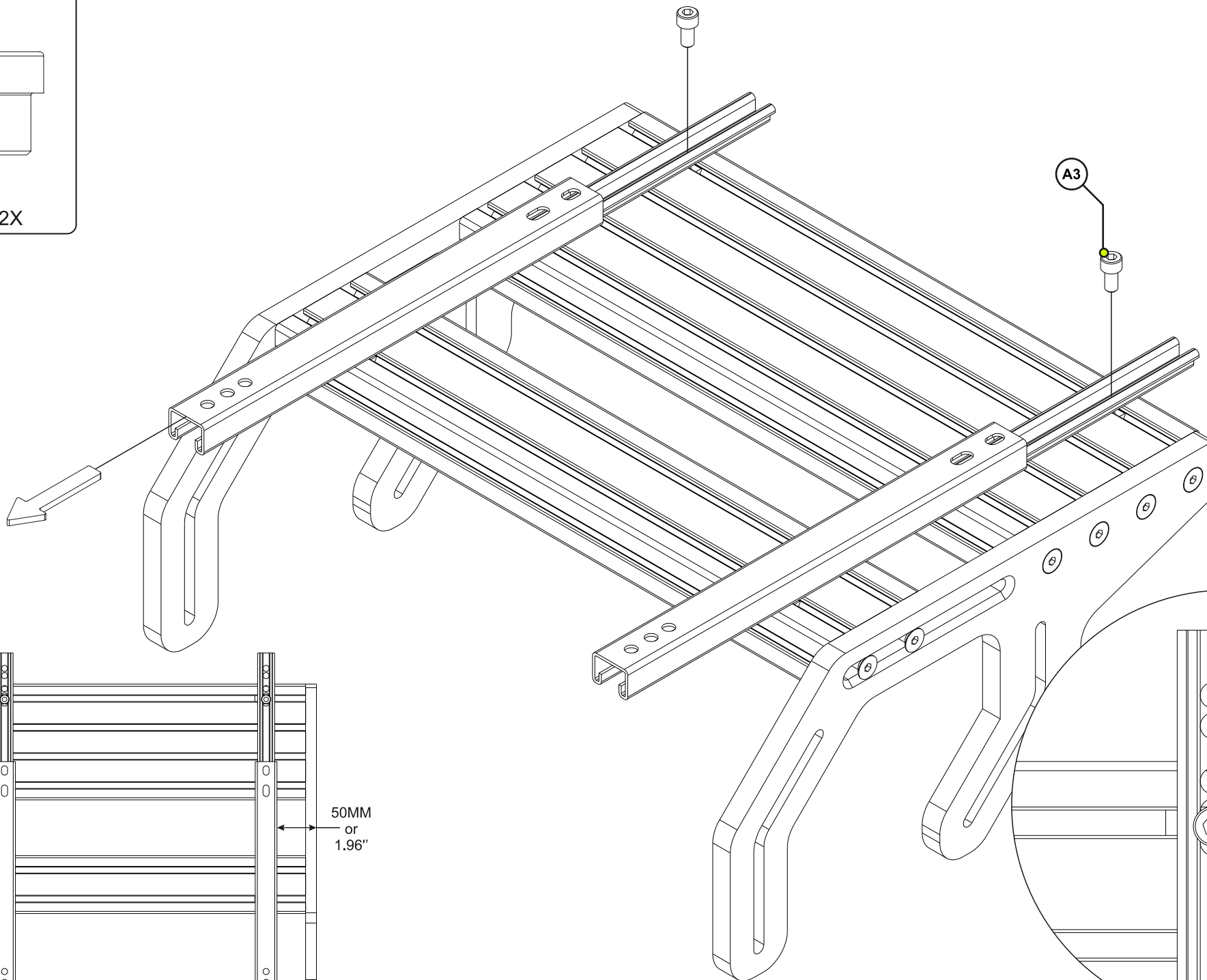

50MM
or
1.96"

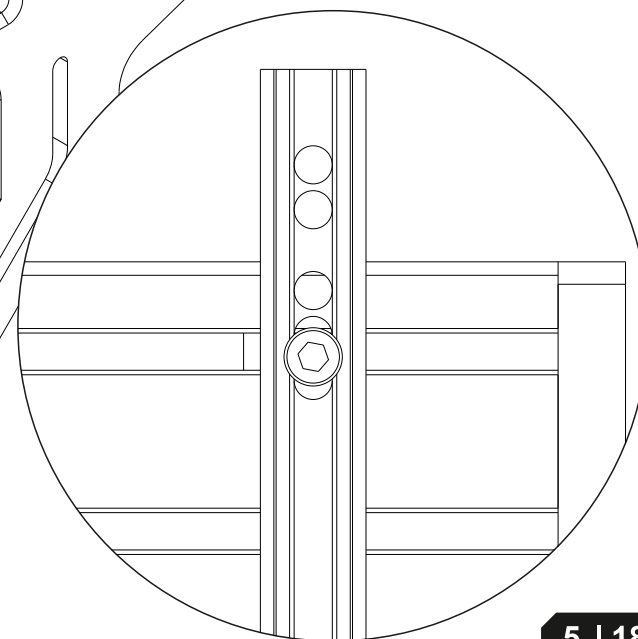

Spacer
M8 X 15

Washer M8

Lock-Nut M8

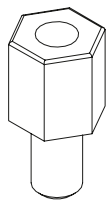

2X

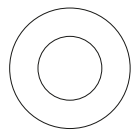

2X

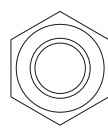

2X

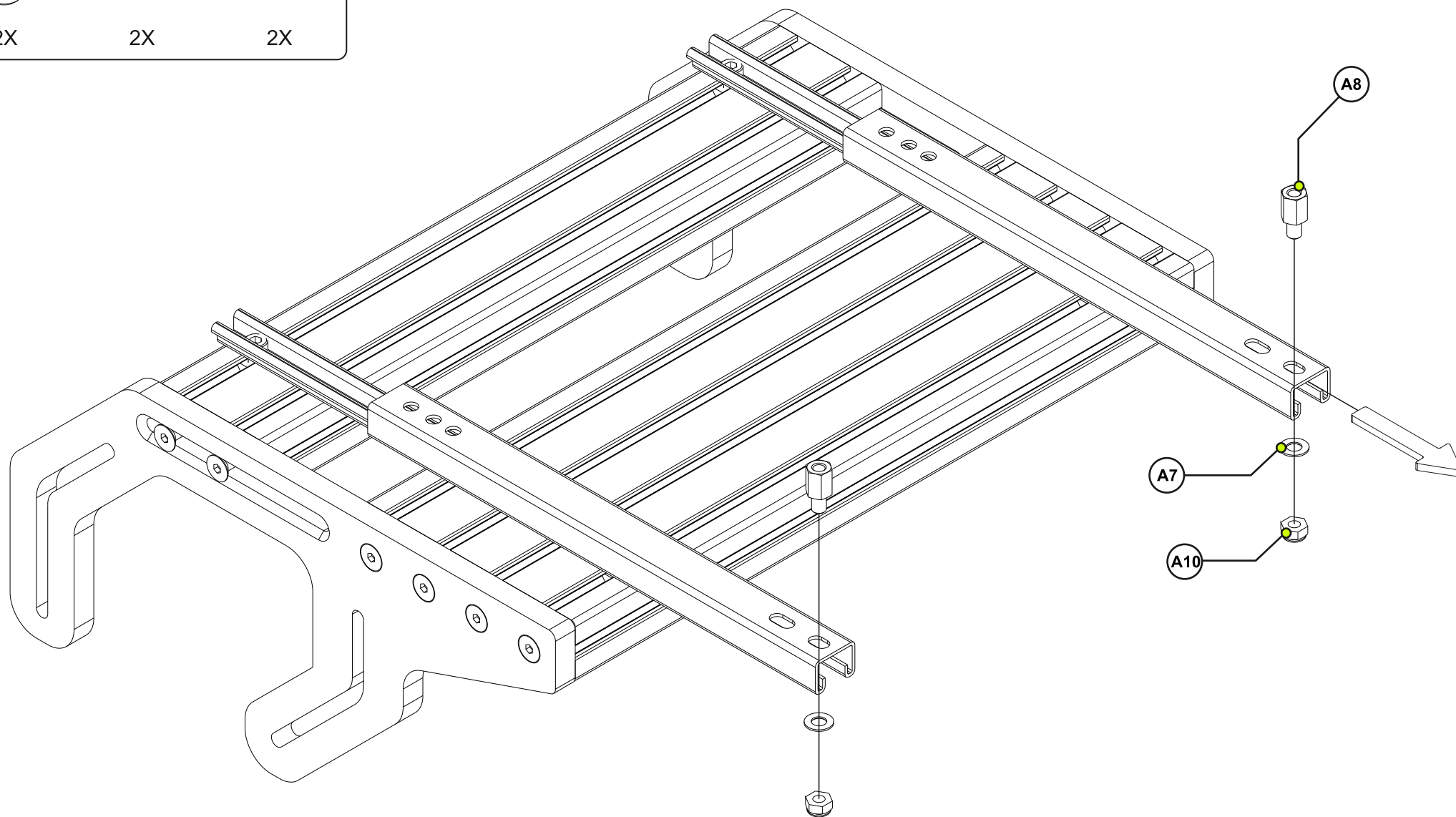

Seat Slider Handle

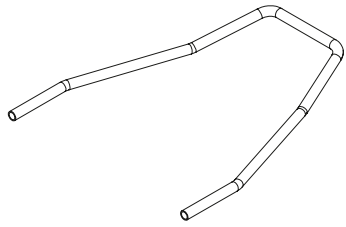

1X

Spacer
M8 X 15

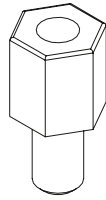

2X

Washer M8

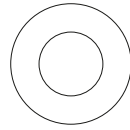

2X

Lock-Nut M8



2X

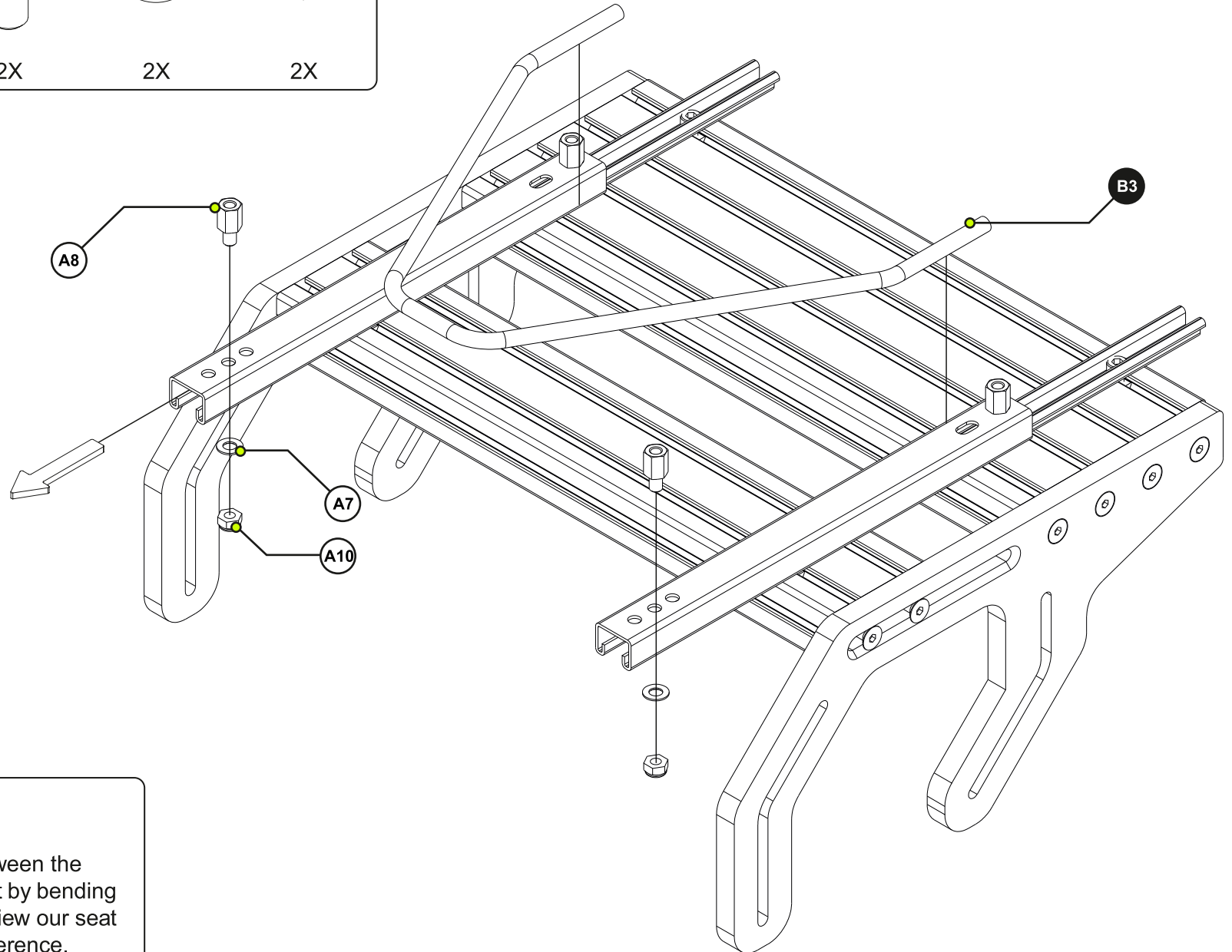

Seat Slider Handle

For the handle to fit snugly between the sliders, it needs to be widened a bit by bending it until it seats properly. Please review our seat slider installation video for reference.

Pedal Baseplate

M8 x 20

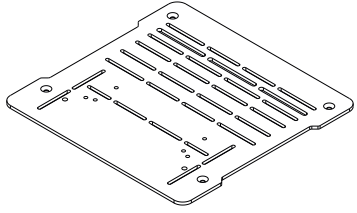

1X

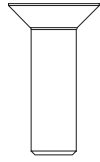

4X

